

INSTALLATION MANUAL

airHome 400

SPLIT TYPE AIR CONDITIONER

INDOOR UNIT
RAK-DJ07QHAA
RAK-DJ09RHAA
RAK-DJ12RHAA



EN INSTRUCTION MANUAL

FOR SERVICE PERSONNEL ONLY

- Carefully read through the procedures of proper installation before starting installation work.
- The sales agent should inform customers regarding the correct operation of installation.

Tools Needed For Installation Work

- (Mark is exclusive use tool for R32)
- Screwdriver
- Measuring Tape
- Knife
- Saw
- ϕ 2-18/32" (65mm) Power Drill
- Hexagonal Wrench Key ($\frac{1}{2}$ " 5/32"(4mm), 21/32"(17mm), 24/32"(19mm), 28/32"(22mm))
- Gas Leakage Detector
- Pipe Cutter
- Putty
- Vinyl Tape
- Pliers
- Flare Tool
- Vacuum Pump Adaptor
- Manifold Valve
- Charge Hose
- Vacuum Pump

SAFETY PRECAUTION

Read the safety precautions carefully before operating the unit. This appliance is filled with R32.

- The contents of this section are vital to ensure safety. Please pay special attention to the following sign.
- WARNING** Incorrect methods of installation may cause death or serious injury.
- CAUTION** Improper installation may result in serious consequence.
- Make sure to connect earth line.**
- This sign in the figures indicates prohibition.**



Access the full version of the User Installation Manual by scanning the code.

Cooling & Heating

<IA2669: © >

The Choice of Mounting Site (Please note the following matters and obtain permission from customer before installation).

CAUTION

- A circuit breaker must be installed in the house distribution box for the direct connected power supply cables to the outdoor unit. In case of other installations a main switch with a contact gap or more than 4/32" (3mm) has to be installed. Without a circuit breaker, the danger of electric shock exists.
- Do not install the unit near a location where there is flammable gas. The outdoor unit may catch fire if flammable gas leaks around it.
- Please ensure smooth flow of water when installing the drain hose. Improper installing may wet your furniture.
- Piping shall be suitable supported with a maximum spacing of 3-9/32" (1m) between the supports.
- Please ensure field selected electrical components (switches, wires, etc) are following approved local regulation requirements.

WARNING

This appliance is filled with R32

CAUTION

This symbol shows that the Operation Instructions should be read carefully.

CAUTION

This symbol shows that a service personnel should be handling this equipment with reference to the Installation Manual.

CAUTION

This symbol shows that there is information included in the Operation Manual and/or Installation Manual.

- The unit should be mounted at stable, non-vibratory location which can provide full support to the unit.

- CAUTION**
- No nearby heat source and no obstruction near the air outlet is allowed.
 - The clearance distances from top, right and left are specified in figure below.
 - The location must be convenient for water drainage and pipe connection with the Outdoor unit.
 - No nearby leakage risk of flammable gas, and no nearby source of vapor or oil smoke.
 - To avoid interference from noise, please place the unit and its remote controller at least 3.28ft(1m) from the radio and television.
 - To avoid any error in signal transmission from the remote controller, please put the controller far away from high-frequency machines and high-power wireless systems.
 - The installation height should be at least 90-18/32" (2300mm) or more from the floor.
 - The distance from the air outlet to the fire alarm must be at least 59-2/32" (1500mm) and there must be no fire alarm in the front direction of the indoor unit.
 - Do not install the indoor unit in a machine shop, kitchen and laundry rooms when vapor from oil or its mist flows to the indoor unit. The oil will deposit on the heat exchanger, thereby reducing the indoor unit performance and may deform and in the worst case, break the plastic parts of the indoor unit.

Figure showing the Installation of Indoor Unit.

Names of Indoor Components

| No. | Item | Qty |
|-----|---|-----|
| ① | Hanger | 1 |
| ② | Screw for Hanger (5/32 x 1-17/64) (4.1 x 32) | 6 |
| ③ | Holder for Remote Controller | 1 |
| ④ | AAA size Battery | 2 |
| ⑤ | Screw for Remote Controller Holder (1/8 x 5/8) (3.1 x 16) | 2 |
| ⑥ | Remote Controller | 1 |
| ⑦ | Purifying Filter | 2 |

Direction of Piping: Backward piping from left, Connection. There are 6 directions allowed, namely, backward piping, backward piping from left, horizontally piping from right, horizontally piping from left, vertically down from right, vertically down from left.

1 Installation of Hanger, Wall Penetration and Installation of Protection Pipe

- CAUTION**
- The draining of the water container inside the indoor unit can be done from the left. Therefore the hanger must be fixed horizontally or slightly tilted towards the side of drain hose. Otherwise, condensed water may overflow the water container.

Direct Mounting On The Wall

- Please use hidden beams in the wall to hold the hanger.

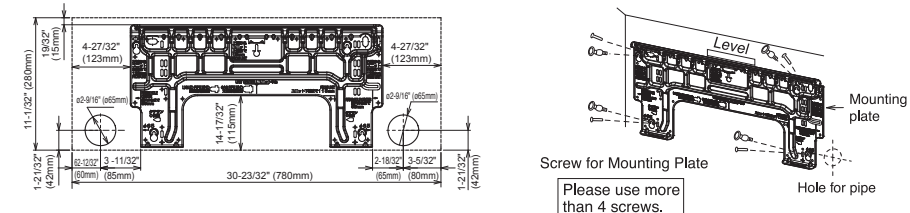

Procedures of Installation and Precautions

- Procedures to fix the hanger.
 - Drill holes on wall. (As shown below)
 - Push plug into the holes. (As shown below)
 - Fix the hanger on wall with 5/32 x 1-17/64 (4.1 x 32) screw (As shown in figure below)
-

- Procedures to fix the holder of remote control.
 - Drill holes on wall. (As shown below)
 - Push plug into the holes. (As shown below)
-

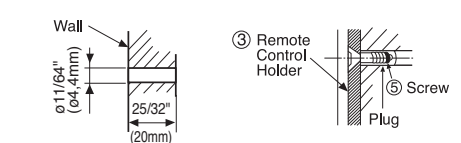

Wall Penetration and Installation of Protection Pipe

- Drill a ϕ 2-18/32" (65mm) hole on wall which is slightly tilted towards the outdoor side. Drill the wall at a small angle.
- Cut the protection pipe according to the wall thickness.
- Empty gap in the sleeve of protection pipe should be completely sealed with putty to avoid dripping of rain water into the room.

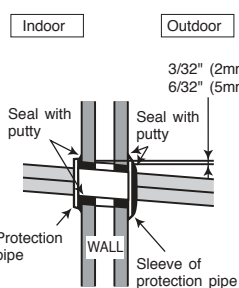

WARNING

Be sure that the wire is not in contact with any metal in the wall. Please use the protection pipe as wire passing through the hollow part of the wall so as to prevent the possibility of damaged by mouse. Unless it seals completely, any air with high humidity flows from outdoor and dew may drop.

2 Installation of the Indoor Unit

Cutting Low Cover bush

- While installing the pipe from the right, left or bottom side, use a knife to cut openings as shown in figure. Then smoothen the edges of openings with a file.

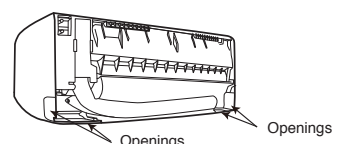

1 PIPING FROM THE RIGHT SIDE (BACKWARD, DOWNWARD, HORIZONTAL)

Preparation

- Connect connecting cord.
- Pull out the pipe, connecting cord and drain hose.

Installation

- Insert the pipe through the wall hole.
 - The upper part of the Indoor unit is hanged on the hanger.
 - The projection at the lower part of the Indoor unit is hooked onto the hanger

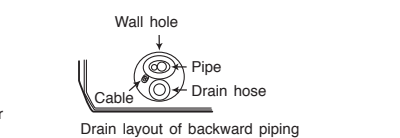
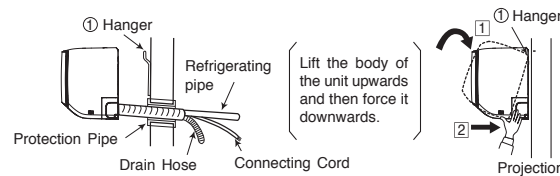

2 PIPING FROM THE LEFT SIDE (BACKWARD, DOWNWARD, HORIZONTAL)

Preparation

Changed of Drain Hose and Installation Procedures

- Exchange the location of drain hose and drain cap while installing the pipe from the left side as shown in below. Be sure to plug in the drain hose until the insulating material folds upon itself.

- Please use pliers to pull out the drain cap. (This is an easier way to remove the drain cap).

CAUTION
Insufficient insert may result in water leakage.

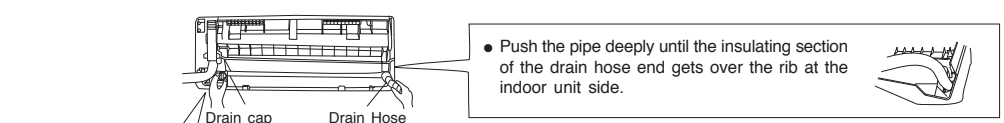

- Remove low cover.
- Insert drain cap up to the location securely till the cap stops.

- CAUTION**
- The rubber strap used for fixing the insulator should not be tied with great force. Otherwise, this will damage heat insulation and causes water condensation..
 - Please pull the lower part of the indoor unit outwards to check if the unit is hooked onto the hanger. Improper installation may cause vibration and noise.
 - Transform the piping while holding down the lower portion of pipe-support by hand.
-
- Labels: Pipe, Rubber strap tied with great force, Pipe support, Transform after bending downward.

THE CONNECTION OF REFRIGERATING PIPE DURING THE INSTALLATION OF INDOOR UNIT

Preparation To Install Refrigerating Pipes

- The refrigerating pipes and connecting cord arrangement are attached.

The end of the refrigerating pipes are at locations marked with "▽" symbol.

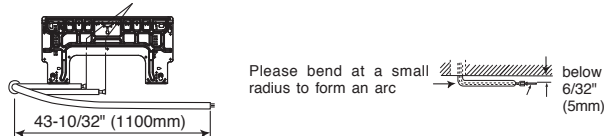

Installation

Hang the Indoor unit onto the hanger. Use the temporary stand at the back of the Indoor unit to push its lower part 5-29/32" (150mm) forwards.

- Place the drain hose through the hole on the wall.
- Wrap the refrigerating pipes with insulation pipe after connecting refrigerating pipe.
- Connect the connecting cord after removing low cover. (Refer to "Connection of Power Cord")
- After adjustment, the connecting cord and refrigerating pipes are placed into the space available under the Indoor unit.
- The projection of Indoor unit must hook to the mounting plate.

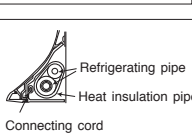
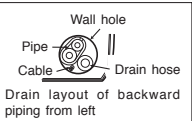
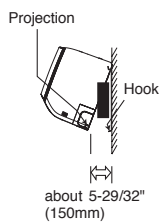

Pull this to the front during the connection of refrigerating pipes to ease task.

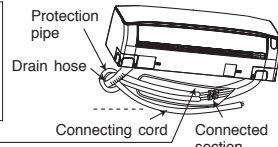

INSTALLATION AFTER CONNECTION OF REFRIGERATING PIPES

- The refrigerating pipe should be adjusted to fit into the hole on the wall and then ready for further connection.
- The terminals of 2 connected pipes must be covered with insulator used for terminal connection. Then the pipes are wrapped with insulating pipe.
- Connect the connecting cord after removing low cover. (Refer to "CONNECTION OF POWER CORD")
- After adjustment, fit the connecting cord and pipes into the space available under the unit. Use holder to hold them tight.
- Be sure to cut the extra binding band. (Otherwise, it may result in abnormal noise or dewfall.)

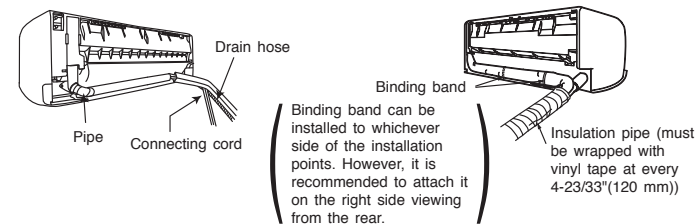

1 Preparation of Pipe

- Use a pipe cutter to cut the copper pipe.



CAUTION

- Remove burr and jagged edge will cause leakage.
- Point the side to be trimmed downwards during trimming to prevent copper chips from entering the pipe.
- Before flaring, please put on the flare nut.

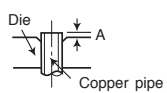
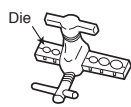

- Please use exclusive tool for refrigerant R32

| Outer diameter in(mm) | Thickness in(mm) | Flare tool for R32 Clutch type | A in(mm) | |
|-----------------------|------------------|--------------------------------|-------------------------------------|--------------------|
| | | | Conventional flare tool Clutch type | Wing nut type |
| 1/4"(6.35mm) | 1/32(0.8) | 0-1/64(0.0-0.5) | 3/64-1/16(1.0-1.5) | 1/16-5/64(1.5-2.0) |
| 3/8"(9.52mm) | 1/32(0.8) | 0-1/64(0.0-0.5) | 3/64-1/16(1.0-1.5) | 1/16-5/64(1.5-2.0) |
| 1/2"(12.70mm) | 1/32(0.8) | 0-1/64(0.0-0.5) | 3/64-1/16(1.0-1.5) | 1/16-3/32(1.5-2.5) |
| 5/8"(15.88mm) | 3/64(1.0) | 0-1/64(0.0-0.5) | 3/64-1/16(1.0-1.5) | 1/16-3/32(1.5-2.5) |

2 Pipe Connection

CAUTION

- In case of removing flare nut of a indoor unit, first remove a nut of small diameter side, or a seal cap of big diameter side will fly out. Free from water into the piping when working.
- Be sure to tighten the flare nut to the specified torque with a torque wrench. If the flare nut is overtightened, the nut may be split after a long period has passed, and may cause a refrigerant leak.

- Please be careful when bending the copper pipe.
- Screw in manually while adjusting the center. After that, use a torque wrench to tighten the connection.

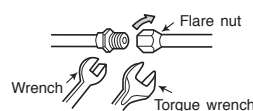

| | Outer dia. of pipe in(mm) | lbf.ft (Torque N.m) |
|-----------------|---------------------------|------------------------------------|
| Small dia. side | 1/4" (6.35) | 10.08-13.68 lbf.ft (13.7-18.6 N.m) |
| | 3/8" (9.52) | 25.20-32.40 lbf.ft (34.3-44.1 N.m) |
| | 1/2" (12.7) | 32.40-39.60 lbf.ft (44.1-53.9 N.m) |
| Large dia. side | 5/8" (15.88) | 36.00-43.20 lbf.ft (49.0-58.8 N.m) |
| | 1/4" (6.35) | 14.40-18.00 lbf.ft (19.6-24.5 N.m) |
| Valve head cap | 3/8" (9.52) | 14.40-18.00 lbf.ft (19.6-24.5 N.m) |
| | 1/2" (12.7) | 21.60-25.20 lbf.ft (29.4-34.3 N.m) |
| Valve core cap | 5/8" (15.88) | 21.31-22.75 lbf.ft (29.0-31.0 N.m) |
| | | 8.75-11.52 lbf.ft (12.3-15.7 N.m) |

Gas Leakage Inspection

Please use gas leakage detector to check if leakage occurs at the connection of Flare nut as shown on the right. If gas leakage occurs, further tighten the connection to stop leakage.

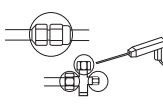

3 Heat Insulation and Finish of the Piping

- The connected terminals should be completely sealed with heat insulator and then tied up with rubber strap.
- Do not tie the terminals with the tape too tight. If any clearance or over-tightening may cause condensation.
- Please tie the pipe and power line together with vinyl tape as shown in the figure showing the installation of Indoor and Outdoor units.
- To enhance the heat insulation and to prevent water condensation, please cover the outdoor part of the drain hose and pipe with insulation pipe.
- Completely seal any gap with putty.

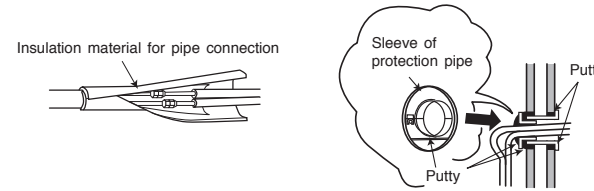

4 Installation of Drain Hose

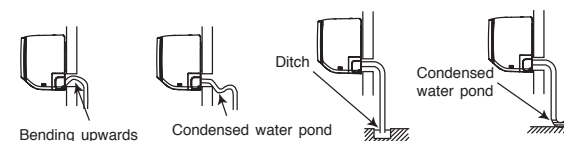

CAUTION

Be sure that the drain hose is not loosely connected or bend or proper condition like left figure.

CAUTION

You are free to choose the side (left or right) for the installation of drain hose. Please ensure the smooth flow of condensed water of the Indoor unit during installation. (Carelessness may result in water leakage.)

WARNING THIS APPLIANCE MUST BE EARTHED.

Detail of Cutting the Connecting Cord

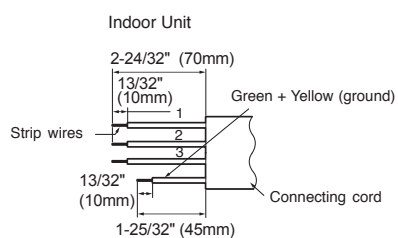

WARNING

- Leave some space in the connecting cord for maintenance purpose and be sure to secure it with the cord band.
- Secure the connecting cord along the coated part of the wire using the cord band. Do not exert pressure on the wire as this may cause overheating or fire.
- Supply cords, current-carrying conductors become taut before earthing conductor, if the cord slips out of the cord band.

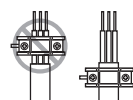

WARNING

- The naked part of the wire core should be 25/64 inch (10mm) and fix it to the terminal tightly. Then try to pull the individual wire to check if the contact is tight. Improper insertion may burn the terminal.
- Be sure to use only power cables approved from the authorities in your country. If the supply cord is damaged, it must be replaced by the manufacturer, its service agent or similarly qualified person in order to avoid a hazard.
- Please refer to the following for wire connection to the terminals of the units. The cabling must meet the standards of electrical installation.

Checking for the electric source and the voltage range

- Before installation, the power source must be checked and necessary wiring work must be completed. To make the wiring capacity proper, use the wire gauge list below for the wiring from house distribution fuse box to the outdoor unit in consideration of the locked rotor current.
- Investigate the power supply capacity and other electrical conditions at the installation location. Depending on the model of room air conditioner to be installed, request the customer to make arrangements for the necessary electrical work etc. The electrical work includes the wiring work up the outdoor. In localities where electrical conditions are poor, use of a voltage regulation is recommended.

Wiring Of The Indoor Unit

- For wire connection of the Indoor unit, you need to remove front panel and electrical cover.
- Method to remove front panel
- Please refer to Instruction Manual - "Removing the Front Panel" under "Cleaning of Front Panel".

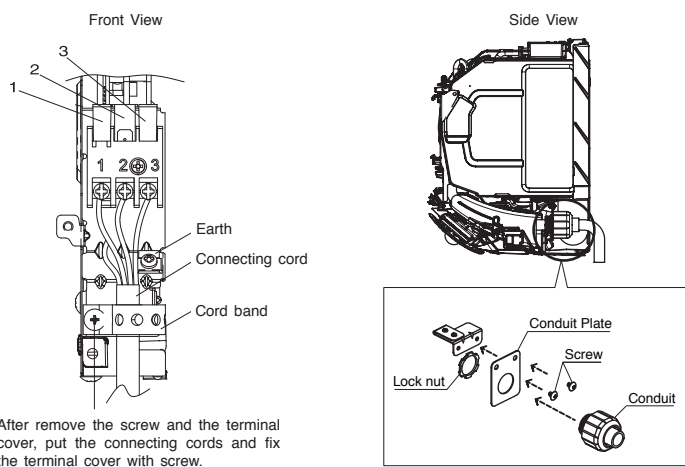

Method to remove the low cover

- Pull at the 1 and 2 in the directions as shown by arrows to remove the cover.



How to connect the optional parts

(H-LINK RAC Adapter, Dry contact, Wired Remote Controller)

- For cable connection to control P.W.B., you need to remove front cover and electrical box cover. Each connecting location is as below.
 - Dry contact: CN6
 - H-LINK RAC Adapter: CN7B
 - Wired Remote Controller: CN20
- Please check and confirm manuals attached to each optional parts for more connection details.
- Please check service manual about how to set from remote controller.
- You can refer to this installation manual how to remove and re-attach the front cover.
- Please be careful not to damage lead wires by edge of plate when connecting the optional parts.
- Please do the operation test after the connection.

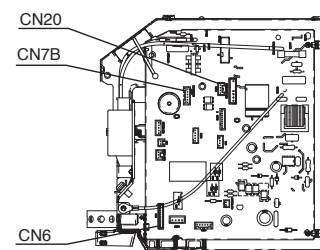

1 HOW TO REMOVE OR ATTACH THE FRONT COVER

How to Remove the Front Cover

- Remove the front panel

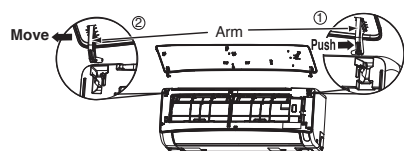

- Push the end of the right-side arm outward to release the tab.
- Move the left-side arm outward to release the left tab, and then pull the panel towards you.
- Remove the filters.
- After removing 3 screws, remove the cover of electric box, pull the center of the front cover towards you and release the claws.
- Pull the side faces (lower sections) of the front cover towards you as shown in the figure and remove the cover.

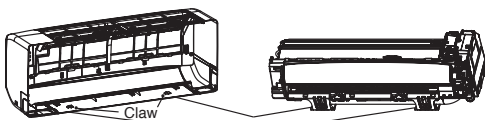

How to Attach the Front Cover

- After installing the front cover onto the unit, hook three claws at upper side of the cover securely. Then, push the center of the front cover to lock the claws.
- Assemble the cover of electric box.
- Tighten the 3 screws.
- Install the filter.
- Attaching the Front Panel
 - Insert the shaft of the left arm along the step on the unit into the hole.
 - Securely insert the shaft of the right arm along the step on the unit into the hole.
 - Make sure that the front panel is securely attached, and then close the front panel.

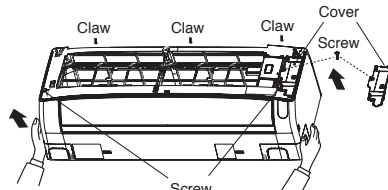

California Proposition 65

WARNING

Proposition 65: This product contains chemicals known to the state of California to cause cancer, birth defects, and other reproductive harm. For more information, go to www.P65Warnings.ca.gov

2 HOW TO REMOVE INDOOR UNIT

- Push up the (PUSH) sections at the bottom of the indoor unit and pull the bottom plate towards you. Then the claws are released from the stationary plate. (The (PUSH) sections are indicated by 2 arrows as below figure)

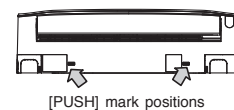

CAUTION

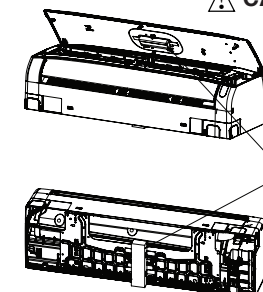

Please remove this spacer as it is for transportation purposes only. Vibration and noise might occur if it is not removed.